

# KIT PANEL

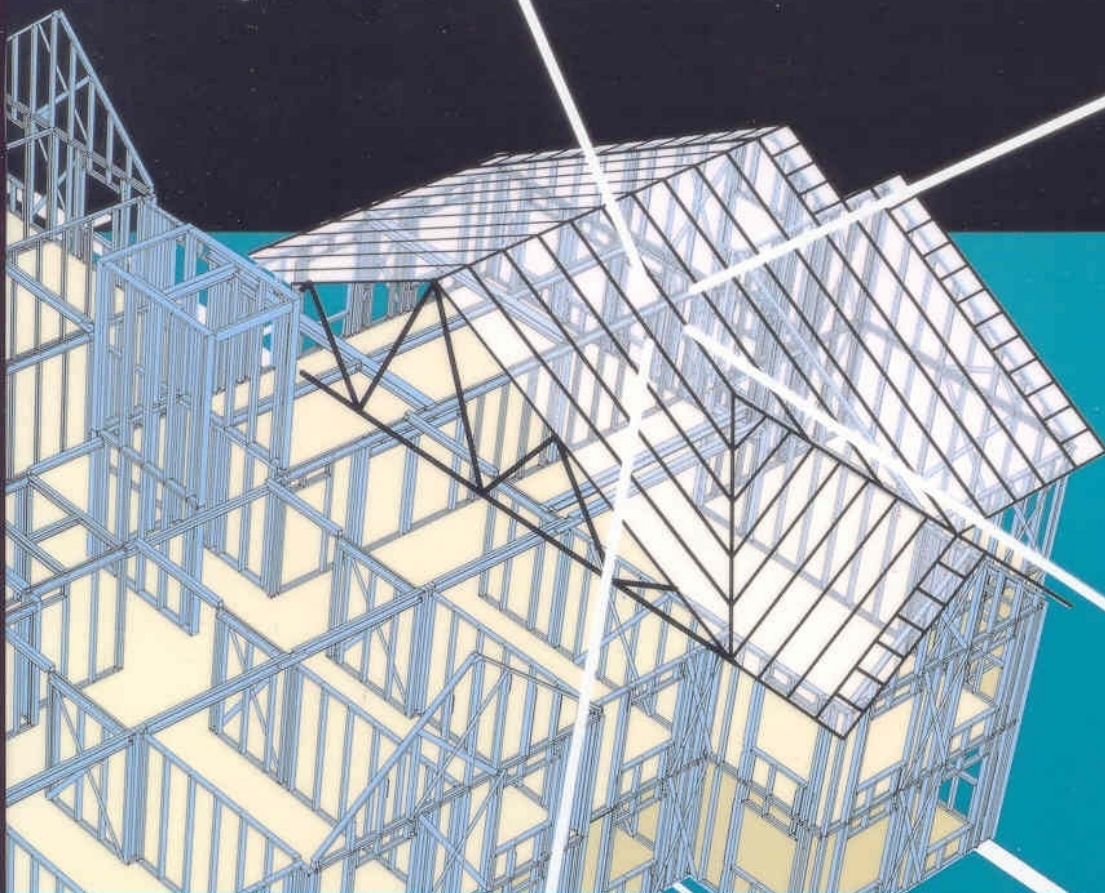

# The “Kit Panel”

Is being used around the world for a variety of applications



Somundy panels may be used for exterior and interior walls, floors, and roofs. Combinations of panels are screwed together along with the leading edge steel to form a building system that is extremely fast, light-weight, and extremely strong. Rough openings for doors and windows are formed during the framing process.

Any type of cladding (i.e. siding, stucco, EIFS, brick, stone) may be field applied to the exterior sides of the panel similar to traditional construction methods.

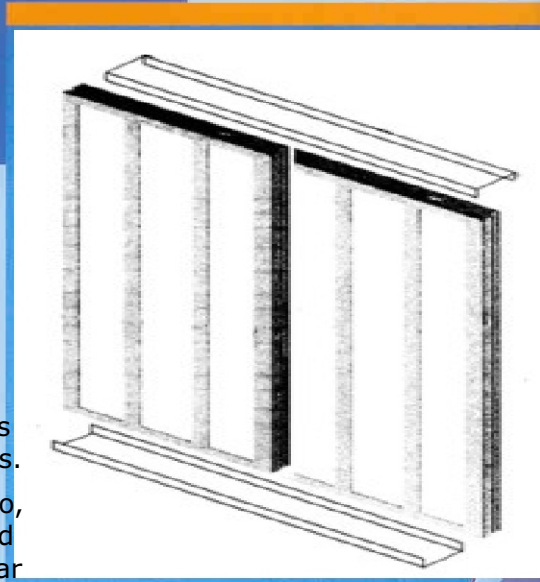

## Panel Specs

Standard panels are 120 cm x 240 cm (4' x 8') and 120 cm x 260 cm (4' x 9'). Studs are manufactured from 1mm (18 gauge), Z275 galvanized steel and are spaced at either 40 cm (16') or 60 cm (24') on center. This steel is also utilized as edge metal at the top and bottom of each panel.

## Facings and Core

Facings are not required until after panels are in place on site. Interiors must be covered with a minimum of 11 mm (1/2") drywall for a minimum 15 minute fire rating. Assemblies are also available with a one-hour or two-hour rating. Exterior may be clad with any type of siding (sheathing already applied).



## Panel attachment system

Panels are connected with hexagonal self-tapping tech screws. This method uses metal tracks for the top and bottom plate.

## Wiring

All Studs come pre-punched openings to allow easy running of electrical wiring.



## Level of Service

A technical representative is available at our offices to review technical details and plans if needed. Local Somundy representatives can provide local technical support. Additional support personnel can be assigned on a per diem basis. A detailed set of shop drawings and an assembly manual will be provided for ease in assembly. Certain designs and regions require a seal or letter of recommendation from a licensed structural engineer. Somundy, for an additional fee, can provide engineering on a case by case basis